

Bocchettone tornito F/F - sede conica

Norme: ISO 228/1 GAS Cilindrico X ISO 228/1 GAS Cilindrico

Materiale: Aisi 304L EN 1.4307 – AISI 316L EN 1.4404

cod. 407

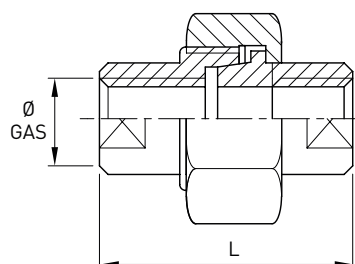

DN	Ø GAS inch	L mm	Stock
8	1/4"	40	D
10	3/8"	43	D
15	1/2"	47	D
20	3/4"	50	D
25	1"	55	D
32	1 1/4"	60	D
40	1 1/2"	67	D
50	2"	68	R
65	2 1/2"	80	R
80	3"	90	R