

Flangia ISO PN10

Norme: Dimensioni compatibili EN 1092-1 TYPE 02

Materiale: Lega di alluminio EN AC-47000

cod. 370

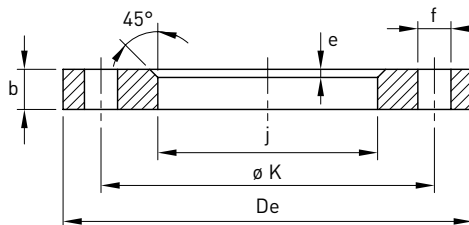

| DN | DN inch | Tubo De mm | Flangia mm | | | | | Foratura | | | Stock | Peso |
|------|---------|------------|------------|------|------|---|----|----------|------|------|-------|-------|
| | | | j | ø K | De | e | b | f mm | Vite | Fori | | |
| 10 | 3/8" | 17,2 | 19 | 60 | 90 | 4 | 12 | 14 | M12 | 4 | D | 0,18 |
| 15 | 1/2" | 21,3 | 24 | 65 | 95 | 4 | 12 | 14 | M12 | 4 | D | 0,19 |
| 20 | 3/4" | 26,9 | 30 | 75 | 105 | 4 | 12 | 14 | M12 | 4 | D | 0,22 |
| 25 | 1" | 33,7 | 36 | 85 | 115 | 4 | 12 | 14 | M12 | 4 | D | 0,28 |
| 32 | 1 1/4" | 42,4 | 46 | 100 | 140 | 4 | 16 | 18 | M16 | 4 | D | 0,57 |
| 40 | 1 1/2" | 48,3 | 54 | 110 | 150 | 4 | 16 | 18 | M16 | 4 | D | 0,65 |
| 50 | 2" | 60,3 | 65 | 125 | 165 | 4 | 16 | 18 | M16 | 4 | D | 0,75 |
| 65 | 2 1/2" | 76,1 | 81 | 145 | 185 | 4 | 16 | 18 | M16 | 4 | D | 0,92 |
| 80 | 3" | 88,9 | 94 | 160 | 200 | 5 | 18 | 18 | M16 | 8 | D | 1,08 |
| 100 | 4" | 114,3 | 119 | 180 | 220 | 5 | 18 | 18 | M16 | 8 | D | 1,26 |
| 125 | 5" | 139,7 | 144 | 210 | 250 | 5 | 18 | 18 | M16 | 8 | D | 1,52 |
| 150 | 6" | 168,3 | 173 | 240 | 285 | 5 | 18 | 22 | M20 | 8 | D | 1,90 |
| 200 | 8" | 219,1 | 225 | 295 | 340 | 5 | 20 | 22 | M20 | 8 | D | 2,71 |
| 250 | 10" | 273 | 279 | 350 | 395 | 5 | 22 | 22 | M20 | 12 | D | 3,72 |
| 300 | 12" | 323,9 | 329 | 400 | 445 | 5 | 22 | 22 | M20 | 12 | D | 4,26 |
| 350 | 14" | 355,6 | 362 | 460 | 505 | 5 | 22 | 22 | M20 | 16 | D | 5,25 |
| 400 | 16" | 406,4 | 413 | 515 | 565 | 6 | 25 | 26 | M24 | 16 | D | 7,20 |
| 450 | 18" | 457,2 | 466 | 565 | 615 | 6 | 25 | 26 | M24 | 20 | D | 7,81 |
| 500 | 20" | 508 | 517 | 620 | 670 | 6 | 28 | 26 | M24 | 20 | D | 9,60 |
| 600 | 24" | 609,6 | 620 | 725 | 780 | 6 | 30 | 30 | M27 | 20 | D | 12,90 |
| 700 | 28" | 711 | 721 | 840 | 895 | 6 | 32 | 30 | M27 | 24 | D | 16,50 |
| 800 | 32" | 813 | 824 | 950 | 1015 | 7 | 36 | 33 | M30 | 24 | D | 26 |
| 900 | 36" | 914,4 | 920 | 1050 | 1115 | 7 | 36 | 33 | M30 | 28 | R | 29 |
| 1000 | 40" | 1016 | 1020 | 1160 | 1230 | 8 | 36 | 33 | M30 | 28 | R | 35 |